



**Havering**  
LONDON BOROUGH

# HIGHWAYS ADVISORY COMMITTEE

10 July 2012

# REPORT

**Subject Heading:**

**APPLETON WAY PROPOSED PAY AND  
DISPLAY PARKING PROVISIONS -  
comments to advertised proposals**

**Report Author and contact details:**

Ben Jackson  
Senior Technical Officer  
01708 431949  
ben.jackson@havering.gov.uk

**The subject matter of this report deals with the following Council Objectives**

Clean, safe and green borough	<input checked="" type="checkbox"/>
Excellence in education and learning	<input type="checkbox"/>
Opportunities for all through economic, social and cultural activity	<input type="checkbox"/>
Value and enhance the life of every individual	<input checked="" type="checkbox"/>
High customer satisfaction and a stable council tax	<input type="checkbox"/>

**SUMMARY**

This report outlines the responses received to the advertised proposals for the introduction of Pay & Display parking provisions in the Appleton Way area, which were agreed in principle by this Committee, and recommends a further course of action.

## RECOMMENDATIONS

That the Highways Advisory Committee recommends to the Cabinet Member for Community Empowerment that either:

1. The proposals as outlined on plans QKxxx/01/02, QKxxx/01/07, QKxxx/01/08A and QKxxx/01/09, be implemented as advertised and for the effects of implementation to be monitored; or
2. The proposals as outlined on plans QKxxx/01/02, QKxxx/01/07, QKxxx/01/08A and QKxxx/01/09 be implemented as advertised with a reduction in the operational hours of the proposed Pay & Display elements to 9.30am – 5pm Monday – Saturday inclusive and for the effects of implementation to be monitored; or
3. The proposals as advertised be abandon and further proposals be designed to incorporate a residents parking scheme.

## REPORT DETAIL

### 1.0 Background

- 1.1 At its meeting on 15<sup>th</sup> November 2011 this committee agreed in principal to introduce pay and display parking facilities in Appleton Way which was presented as item TCP154 Appleton Way, within the Scheme Requests List.
- 1.2 The proposals were subsequently designed and publicly advertised. The proposals are described below and are shown on the attached plans QKxxx/01/02, QKxxx/01/07, QKxxx/01/08A and QKxxx/01/09.
- 1.3 Consultation letters were delivered to those residents and business affected by the proposed scheme. As part of the consultation notices were placed on site and published in a local newspaper.

This report looks at the responses received to the consultation and with staff comments, recommends a further course of action.

### 2.0 Scheme Elements

- 2.1 The proposals are to implement Pay & Display parking restrictions operational between 9.30am and 6.30pm Monday to Saturday inclusive, in the existing Free Parking Bays in Appleton Way and to create 8 new Pay & Display parking bay in Victor Gardens, close to its junction with Appleton Way, with associated footway

works, 3 new bays in the area of Appleton Way behind 114 High Street, 3 new bays in the area of Appleton Way adjacent to the island to the rear of No.136 High Street and 1 new bay to the rear of No.6 Station Lane. This element of the scheme has now been dropped, due to the Regeneration works in this area. The proposals also make provision for the introduction of new Disabled Parking Bays to the rear of No.94 High Street, adjacent to the electricity sub station, to the rear of 158 High Street and adjacent to the island opposite Brazemore House.

### **3.0 Responses received**

3.1 There were 143 consultation letters sent out to residents and businesses in the area of the proposals and at the close of public consultation 7 responses were received, which equates to a 4.9% return. The responses are summarised and appended to this report as Appendix A.

### **4.0 Staff Comments**

4.1 From the responses received which are mainly from residents it is clear that they are experiencing parking problems, due to the fact that they have no allocated parking to their flats. The residents are currently parking in the existing free parking bays; which is proving to be problematic. Long-term parking during the day is regularly taking place in these free parking bays and there would seem to be increasing level of vehicles being left over night. There is currently no resident parking provision in the Hornchurch Town Centre, although there are a number of dwellings that rely on parking within town centre side roads. By controlling the length of stay in the existing free parking bays by implementing a Pay & Display provision, this would limit long-term parking and provide further facilities for user of the town centre. However it is recognised that these proposals will impact on the residents currently using the existing free parking facilities. Consideration could be given to reduce the hours of operation of the Pay & Display elements of the scheme to 5pm, which may limit the impact on some residents.

## **IMPLICATIONS AND RISKS**

### **Financial implications and risks:**

The estimated cost of implementing the proposals as described above and shown on the attached plan is £10,000 including advertising costs, sign and linings and the construction of a small section of footway in Victor Gardens, but excluding the installation of Pay and Display machines at six locations.

The estimated cost to install the proposed Pay & Display machines as set out in this report is £28,000. These elements of the scheme are MTFS approved and can be funded by a current Invest to Save bid.

## **Highways Advisory Committee, 10 July 2012**

The costs shown are an estimate of the full costs to implement a scheme should it be ultimately implemented. It should be noted that further decisions are to be made following a full report to the Committee and with the Cabinet Member approval process being completed where a scheme is recommended for implementation.

Overall costs will need to be contained within the overall revenue budget.

### **Legal implications and risks:**

Waiting restrictions and parking bays require consultation and the advertisement of proposals before a decision can be taken on their introduction.

### **Human Resources implications and risks:**

The collection of cash from pay and display machines is a labour intensive task. Currently, there are sufficient employees to undertake cash collection from existing P&D machines. However, whilst there may be a marginal level of additional capacity brought about by a reduction in cash collection schedules and frequency there will be an inevitable increase of risk from cash theft if money is left in situ for longer. That said, a physical limit for cash collections will soon be reached and so consideration will need to be given to additional employees to undertake increased levels of cash collection at a later stage.

However, for this scheme it is anticipated that collections can be met from within current staff resources.

### **Equalities implications and risks:**

Parking restrictions in residential areas are often installed to improve road safety and accessibility for residents who may be affected by long-term non-residential parking.

Parking restrictions have the potential to displace parking to adjacent areas, which may be detrimental to others.

Disabled 'Blue' Badge holders are able to park with an unlimited time in resident permit bays and in Pay & Display parking bays and for up to three hours on restricted areas (unless a loading ban is in force).

**BACKGROUND PAPERS**

Drawings:

QKxxx/01/02

QKxxx/01/07

QKxxx/01/08A

QKxxx/01/09

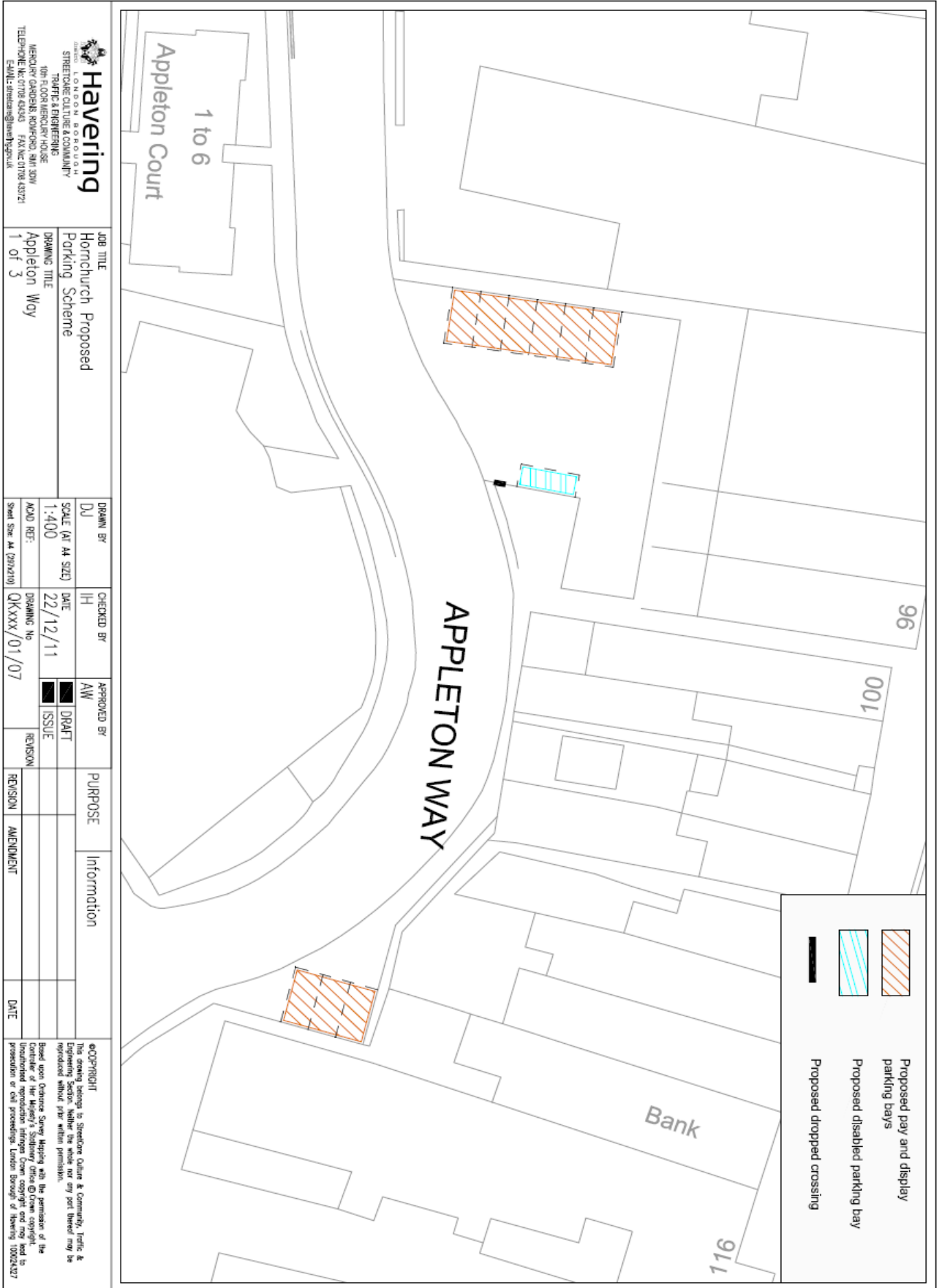

**Having**  
ENGINEERING  
 LONDON BOROUGH  
 STREETCARE CULTURE & COMMUNITY  
 TRAFFIC & ENGINEERING  
 10th FLOOR MERCURY HOUSE  
 MERCURY GARDENS ROYALTON, RM1 3JW  
 TELEPHONE: 01708 634343 FAX: 01708 633721  
 EMAIL: [traffic@having.co.uk](mailto:traffic@having.co.uk)

**JOB TITLE**  
 Horchurch Proposed  
 Parking Scheme  
**DRAWING TITLE**  
 Appleton Way  
 1 of 3

**DRAWN BY**  
 DJ  
**SCALE (AT A4 SIZE)**  
 1:400  
**ADWD REF:**  
 Small Str. A4 (29/12/10)  
**CHECKED BY**  
 IH  
**DATE**  
 22/12/11  
**DRAWING No**  
 QKxxx/01/07  
**APPROVED BY**  
 AW  
**DRAFT**  
 ISSUE  
**REVISION**

**PURPOSE**  
 Information  
**REVISION**  
 AMENDMENT  
**DATE**

**©COPYRIGHT**  
 This drawing belongs to Streetcare Culture & Community, Traffic & Engineering Section. Neither the whole nor any part thereof may be reproduced without prior written permission.  
 Based upon Ordnance Survey Mapping with the permission of the Controller of Her Majesty's Stationery Office © Crown copyright. Unauthorised reproduction infringes Crown copyright and may lead to prosecution or civil proceedings. London Borough of Havering 10026287

	Proposed pay and display parking bays
	Proposed disabled parking bay
	Proposed dropped crossing

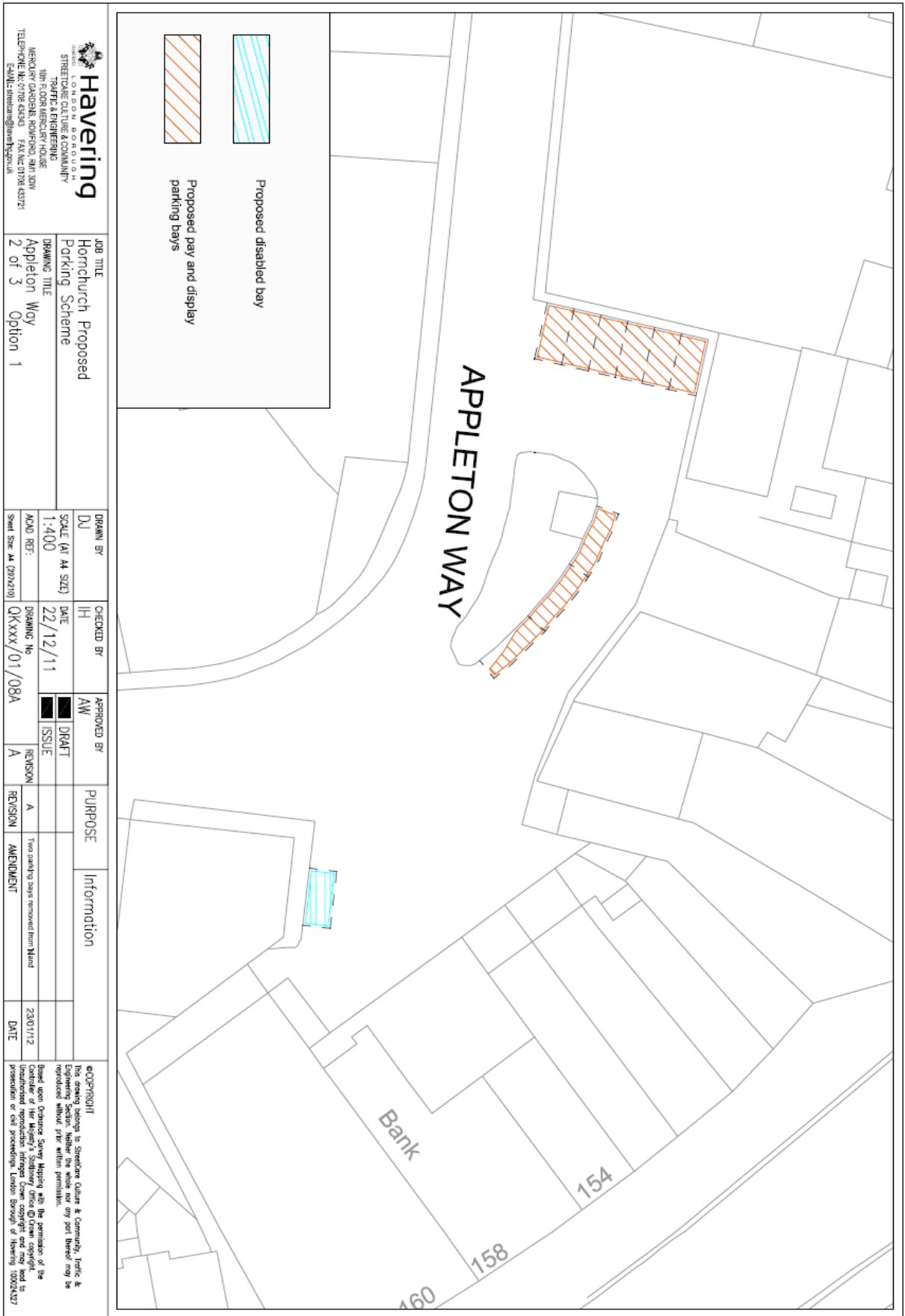

<b>Havering</b> COUNCIL OF THE BOROUGH OF STRETTON, CULTURE & COMMUNITY TRAFFIC & ENGINEERING MERCURY GARDENS, ROCHFORD, HA1 3DW TELEPHONE: 01783 64343 FAX: 01783 64372 EMAIL: <a href="mailto:stretdem@havtraffic.uk">stretdem@havtraffic.uk</a>		JOB TITLE Horchurch Proposed Parking Scheme DRAWING TITLE Appleton Way 2 of 3 Option 1		DRAWN BY DJ SCALE (A1 A4 SIZE) 1:400 A4/D1 REF: Sheet Size: A4 (297x210)		CHECKED BY IH DATE 22/12/11 DRAWING No QKxxx/01/08A		APPROVED BY AW DRAFT ISSUE REVISION A		PURPOSE Information Two parking bays removed from plan AMENDMENT DATE 23/01/12		COPYRIGHT This drawing belongs to Stretdone Culture & Community, Traffic & Engineering Section. Neither the whole nor any part thereof may be reproduced without prior written permission. Based upon Ordnance Survey Mapping with the permission of the Controller of Her Majesty's Stationery Office © Crown copyright and not to be reproduced in any proceedings. London Borough of Havering 10062627	
--	--	---	--	---	--	--	--	--	--	---	--	---	--

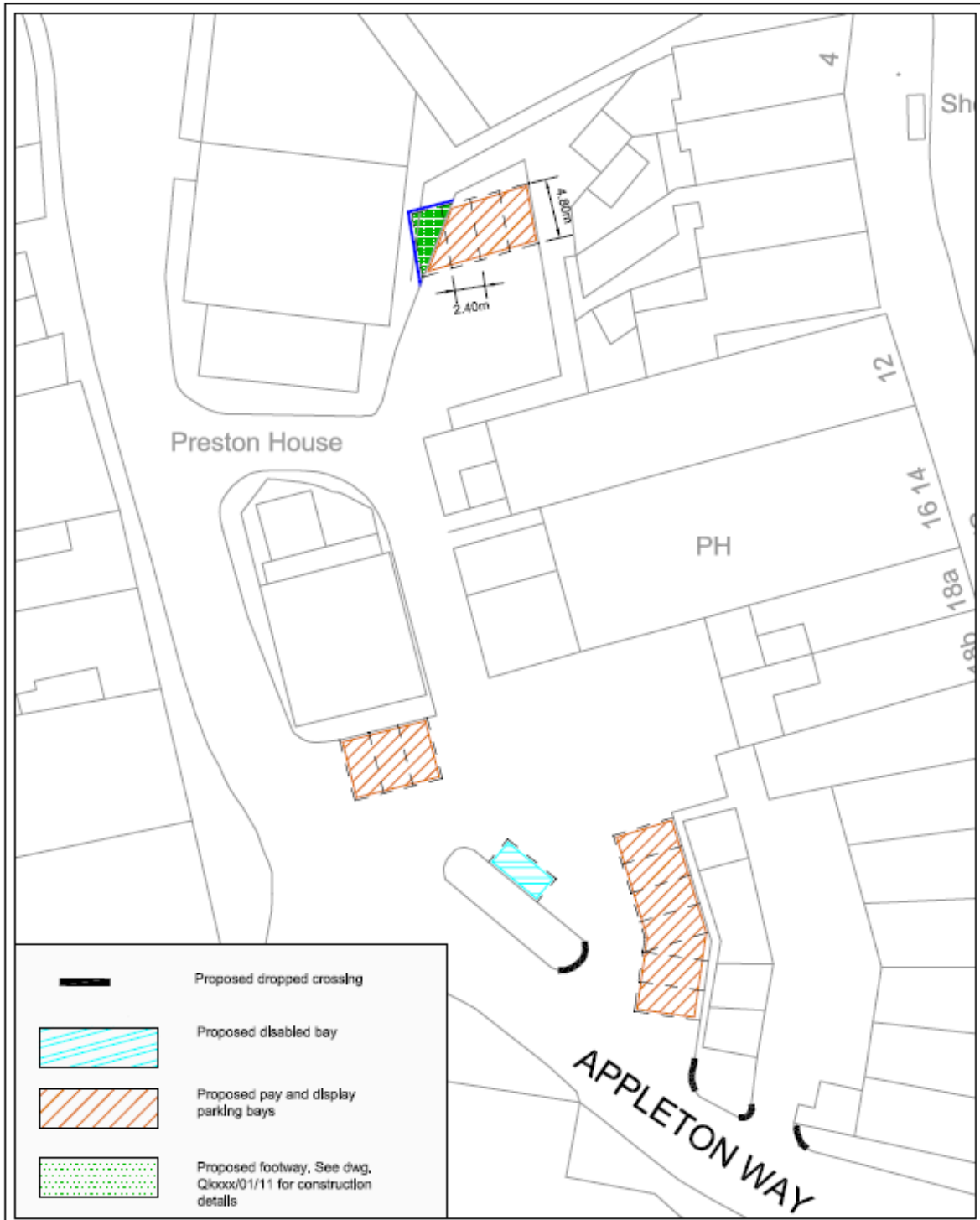

<b>Havering</b> <small>LONDON BOROUGH</small> <small>STREETS - CULTURE &amp; COMMUNITY</small>		<b>1001 11200</b> <b>MINOR</b> <b>ROADS</b> <b>SECTION OFFICER</b> <b>0203 261 259</b> <b>TELEPHONE No 01189 84343</b> <b>FAX No 01189 43291</b> <b>E-MAIL: <a href="mailto:streets@haring.gov.uk">streets@haring.gov.uk</a></b>	<b>PURPOSE</b> Information	<b>©COPYRIGHT</b> This drawing belongs to StreetCare Culture & Community, Traffic & Engineering Section. Neither the whole nor any part thereof may be reproduced without prior written permission.  Based upon Ordnance Survey Mapping with the permission of the Controller of Her Majesty's Stationary Office © Crown copyright. Unauthorised reproduction infringes Crown copyright and may lead to prosecution or civil proceedings. London Borough of Havering 10024327									
<b>JOB TITLE</b> Hornchurch Proposed P&D Parking Scheme		<b>DRAWN BY</b> DJ	<b>CHECKED BY</b> JH	<b>APPROVED BY</b> AW									
<b>DRAWING TITLE</b> Appleton Way 3 of 3		<b>ACAD REF:</b> Street Size: A4 (211x297)	<b>DRAWING No</b> QKxxx/01/09	<b>REVISION</b> B									
<b>SCALE (AT A4 SIZE)</b> 1:400	<b>DATE</b> 22/12/11	<b>DRAFT</b>	<b>ISSUE</b>	<table border="1"> <tr> <td>B</td> <td>One bay added to the no 4 Station Lane</td> <td>23/01/12</td> </tr> <tr> <td>A</td> <td>One bay removed from the no 4 Station Lane</td> <td>20/01/12</td> </tr> <tr> <td>REVISION</td> <td>AMENDMENT</td> <td>DATE</td> </tr> </table>	B	One bay added to the no 4 Station Lane	23/01/12	A	One bay removed from the no 4 Station Lane	20/01/12	REVISION	AMENDMENT	DATE
B	One bay added to the no 4 Station Lane	23/01/12											
A	One bay removed from the no 4 Station Lane	20/01/12											
REVISION	AMENDMENT	DATE											

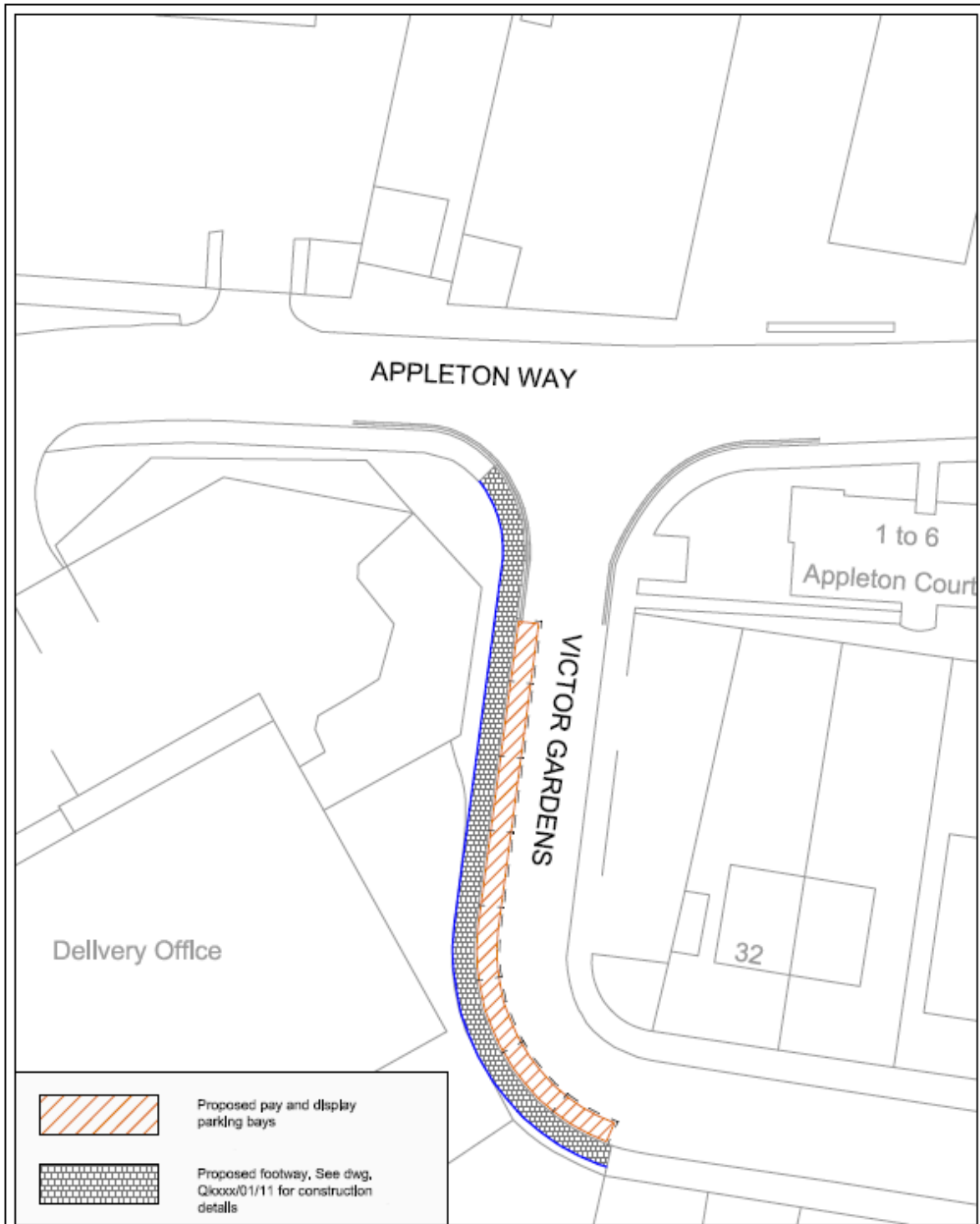

<p>100, 11200 MARKET ROAD MIDLAND SQUARE SCARLETT, N15 2JH TELEPHONE No 01753 434343 FAX No 01753 432721 E-MAIL: <a href="mailto:street@haverling.gov.uk">street@haverling.gov.uk</a></p>		<b>PURPOSE</b> Information									
<b>JOB TITLE</b> Hornchurch Proposed P&D Parking Scheme		<b>©COPYRIGHT</b> This drawing belongs to StreetCare Culture & Community, Traffic & Engineering Section. Neither the whole nor any part thereof may be reproduced without prior written permission.									
<b>DRAWING TITLE</b> Victor Gardens 1 of 2		Based upon Ordnance Survey Mapping with the permission of the Controller of Her Majesty's Stationary Office © Crown copyright. Unauthorised reproduction infringes Crown copyright and may lead to prosecution or civil proceedings. London Borough of Havering 100004327									
		<b>DRAWN BY</b> DJ	<b>CHECKED BY</b> IH	<b>APPROVED BY</b> AW							
<b>SCALE (AT A4 SIZE)</b> 1:400	<b>DATE</b> 22/12/11	<input checked="" type="checkbox"/> DRAFT <input checked="" type="checkbox"/> ISSUE	<b>ACAD REF:</b> Sheet Size: A4 (210x297)	<b>DRAWING No</b> QKxxx/01/02	<b>REVISION</b>						
		<table border="1"> <thead> <tr> <th>REVISION</th> <th>AMENDMENT</th> <th>DATE</th> </tr> </thead> <tbody> <tr> <td> </td> <td> </td> <td> </td> </tr> </tbody> </table>		REVISION	AMENDMENT	DATE					
REVISION	AMENDMENT	DATE									



### **Response 1**

The responses from a resident of the flats above the shops that back on to Appleton Way; outlines that they are strongly opposed to the proposals to change the existing free parking bays to Pay & Display parking bays, as they gain access to their flats from these areas and this is the only area of available free parking space for many flats located on Hornchurch Road. The resident chose the flat due to the free evening parking

### **Response 2**

Traffic and Parking Control received a telephone call from Councillor Mylod out-lining his wishes for residents' comments in respect of residents parking to be considered along with all possible parking solutions to be considered by the Highways Advisory Committee

### **Response 3**

Response from a resident that lives above Costa Coffee outlines that their parking situation is worsening rapidly. They claim that the 5 parking spaces were originally created with a view to providing permits for residents, but this scheme was never put in to operation. They would like to request that this area is allocated to resident parking only. They experience a multitude of parking problems due to shop workers parking during the day and at weekends vehicles are often left in these spaces over night. The resident has unfortunately experienced damage to their vehicle in this area and claims that most of the other parking areas in Hornchurch have been changed to pay and display and with further restrictions being implemented have reduced the available parking space. Additionally, they have to wait for existing free bays to become vacant or have no other option than to use the car parks. They suggest as there are 5 flats and 5 parking bays that the residents will be able to have a scheme for this small area and this feeling is reportedly echoed by their neighbours. The resident is willing to pay annual permit charges for the benefit of parking in the area.

### **Response 4**

This response was received from a resident believed to be from the same property as the aforementioned and echoes the same sentiments. They also find great problems parking near their property to unload shopping. If the parking spaces are made into pay and display they feel they would have nowhere to park at all. They feel they would have to park a mile away if the restrictions are brought into operation, but outlines they along with their neighbours would be happy to pay for parking permits. The resident also feels it's unacceptable for long lines of black cabs to form outside their bedroom window at weekends. Overall the respondent is strongly apposed to the scheme.

### **Response 5**

The response from a business on the High Street, they suggest at these difficult times that implementing pay and display parking in Appleton Way would make Hornchurch less appealing to customers. They have discussed with The Council that shoppers need to be encouraged back to Hornchurch after the problems with the building falling and the gas main replacements. They feel that they are not being listened to and feel that The Council is looking for more ways in which to make money.

### **Response 6**

## **Highways Advisory Committee, 10 July 2012**

Response from a resident that resides above the shops outlines that they use the existing free bays to park their car and changing the facility to pay and display will result in them not being able to park outside their property. The parking facilities in near-by streets are very limited and it is considered that they will have to park a distance away from the property if the proposals are implemented. Further to this they feel as a tax payer this situation is unacceptable, that no consideration has been given to the residents who reside and use the parking and feels that the plans should be reviewed and resident parking only should be created.

### **Response 7**

The resident is unhappy with the proposals as there are five flat that back on to this section of Appleton Way with five parking spaces in the area to the rear of the flats. It is felt that it would be unfair if these parking bays were not made for residents parking, as it is difficult to park in these spaces. They fell that they are paying a lot of Council tax and they won't have anywhere to park their cars.